

Mapping the History of Tod Inlet

A Report Submitted to the B.C. Parks Branch

March 2002

by David R. Gray

Keys to accompany the maps created for the report

KEY (also key for Figures 2 and 3)

1. Slurry Mixer (concrete)
2. Slurry Mixer (concrete)
3. Concrete chimney/stack (1916?-2002+)
4. New Mill
5. Two concrete chimney/stacks (1916-1978?)
6. Aerial Tram Terminal
7. Brick chimney/stack
8. Kilns (steel and concrete posts supporting concrete roof)
9. Open area (formerly Grinding Mills)
10. Machinery Storage (formerly Engine and Boiler Rooms)
11. Stock House No. 1 (concrete)
12. Coal House
13. Stock House No. 2 (concrete)
14. Rail line taking rock to coast for dumping
15. Wharf
16. First Wharf with Loading Warehouse (1905-1970s)
17. Coal Unloading (roof only)
18. Bag Warehouse, with Pump House and Sack Cleaner
19. Dynamo [?] (concrete)
20. Blacksmith Shop (concrete), with Supply Warehouse attached (concrete)
21. Office Building, (Oil Room 1st floor), Offices, including Post Office, 2nd floor (concrete)
22. Tile Plant (1921-1980?)
23. Transformers and Sub Station, concrete (190? -19??)
24. Machine Shop, concrete (190?- 1980?)
25. Laboratory, wood frame (1905-1940?)
26. Mess House, concrete [?] (1905-1978?)
27. Larder, concrete with wooden roof
28. Bunk House, two-story, concrete (1905-1958?)
29. Small boat wharf
30. Small boat wharf
31. Wood Frame House, two story, concrete foundation (1905-1978?)
32. Wood Frame House, two story, concrete foundation (1905-1978?)
33. Wood Frame House, two story, concrete foundation (1905-1978?)
34. Wood Frame House, two story, concrete foundation (1905-1978?)

35. Foreman's House, wood frame, two story, concrete foundation (Carrier 19??- 1978)
36. Tennis Court
37. Wood Frame House, concrete foundation (1905-1978?)
38. Wood Frame House, concrete foundation (1905-1978?)
39. Wood Frame House, concrete foundation (1905-1978?)
40. Wood Frame House, concrete foundation (1905-1978?)
41. Wood Frame House, concrete foundation (1905-1978?)
42. Wood Frame House, concrete foundation (1905-1978?)
43. Wood Frame House, concrete foundation (1905-1978?)
44. Wood Frame House, concrete foundation (1905-1978?)
45. Wood Frame House, concrete foundation (1905-1978?)
46. Ireland's Store/House
47. Pasture
48. Stable, concrete (1905-1994)
49. Laundry House 1905?-1970s? (Tong's House 1950s?-1970s?)
50. Three large pits (perhaps toilet pits?)
51. Small brick structure (possibly ovens?)
52. Chinese House ? (foundation only)
53. Chinese House ? (foundation only)
54. Chinese House ? (foundation only)
55. Sikh/Chinese House ? (cement foundation with brick ovens)
56. Chinese Bunk House ?, 2 story ?
57. Farm buildings (barn and outbuildings)
58. Bridge over Tod Creek (former road to Victoria)
59. Clay Mill (concrete foundation) and end of electric railway
60. Rock dump from end of electric railway into Tod Creek
61. Electric Railway Switching House
62. The Gully
63. Clay Quarry
64. Upper Quarry (now Quarry Lake)
65. Debris piles (rock from quarry?)
66. Quarry apparatus and conveyor over Interurban Railway line
67. Aerial Tram
68. Chinese Woodcutters Cabin ?
69. Beetlestone's Cabin (*See number label on Figure 1*)

Figure 5. Map of Tod Inlet 2002 showing location of Significant Artifacts and Building Remnants.

KEY

1. Frame of trolley dump cart in clay pit area south of Wallace Drive (44 X 35").
2. Clay bucket/scrapper on terrace above clay pit on Wallace Drive (53 X 61 X 25").
3. Wheel for overhead (Tefler?) bucket line "Pat'd Mar 26 1895, 9-1911" (16" diameter). At second tower of aerial tramline from Wallace Drive.
4. Unidentified Metal jackets? for clamping pipeline joints? North of old stable. Large size 11 x 9", small 8" long.
5. Roof ventilator shaft, north of old stable.
6. Remnants of aerial tramway towers and cables.
7. Marine engine on beach at southeast end of Tod Inlet (below former log dump).
8. Cast iron stove (small 15 x 20 x 9 inches, from boat?) on south side of Inlet.
9. Railway axel and flanged wheels from marine railway ("the ways") on beach near ways.
10. Sack of cement, partial, without sacking but with imprint of sacking, about 15" in diameter.
11. Length of large drill (about 5 to 6 feet long) with mass of other rusting metal in remnants of north wharf.

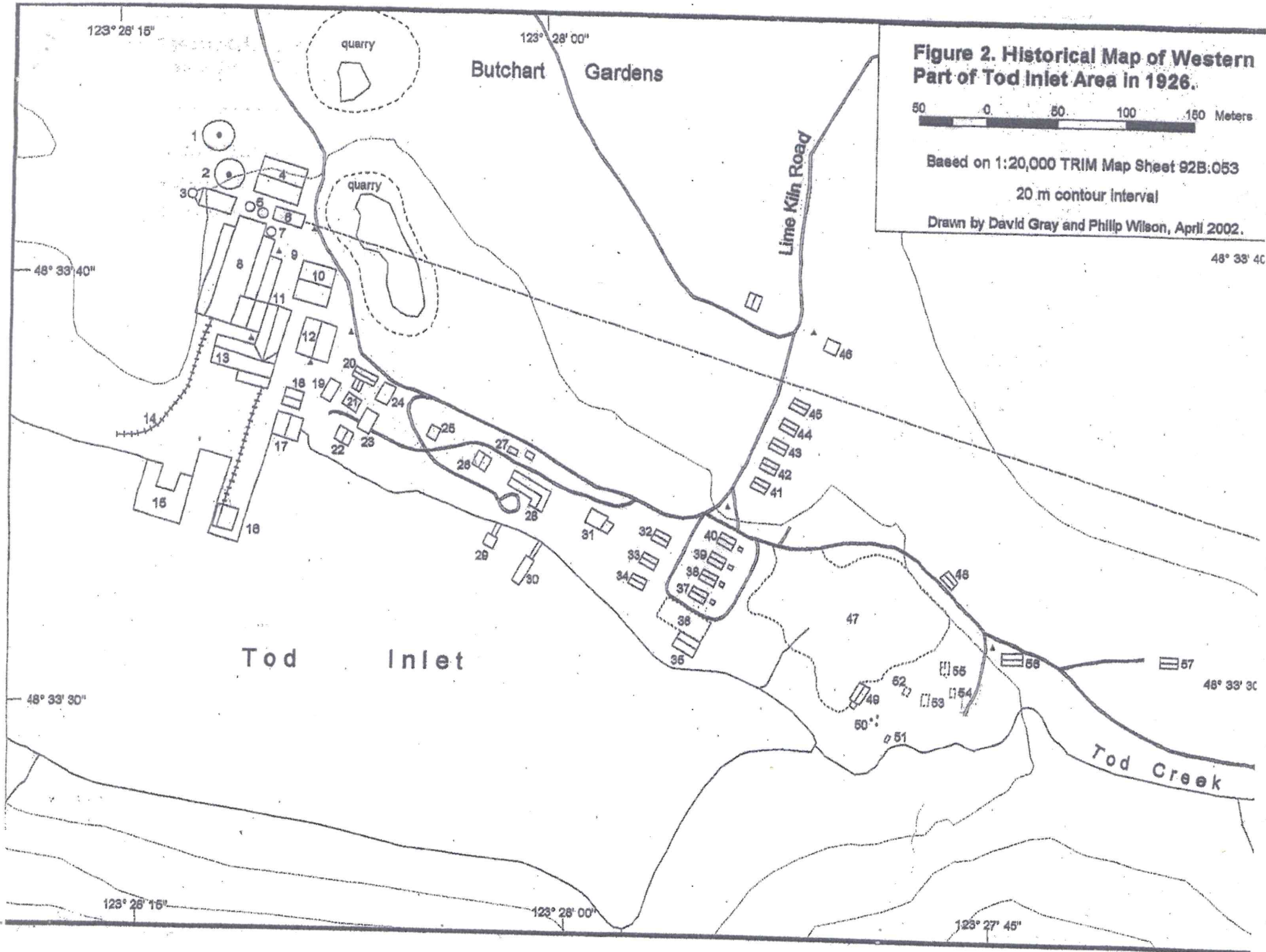

3° 27' 45"

123° 27' 30"

Figure 3. Historical Map of Eastern Part of Tod Inlet Area in 1926.

Based on 1:20,000 TRIM Map Sheet 92B.053

20 m contour interval

Drawn by David Gray and Philip Wilson, April 2002.

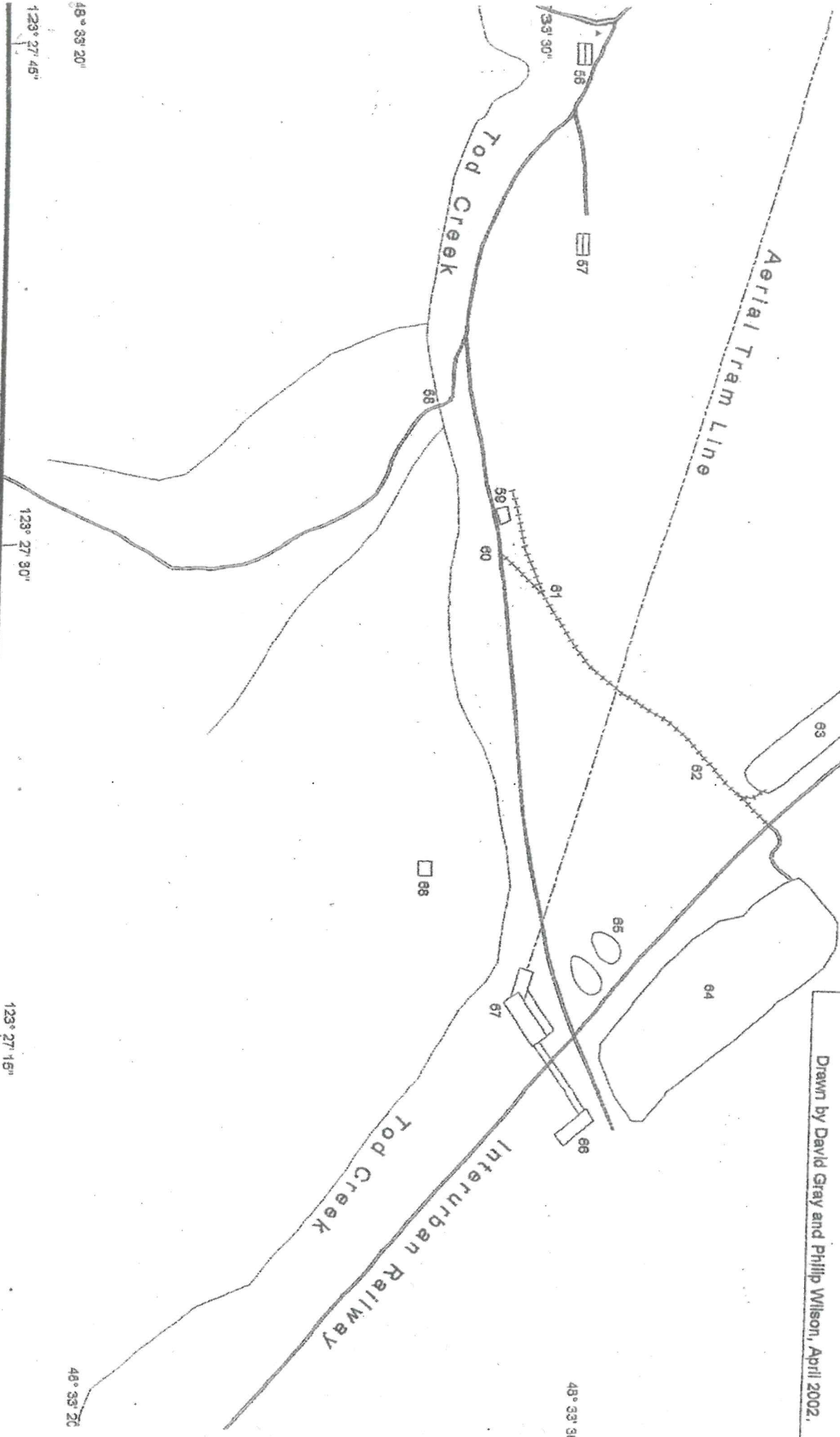
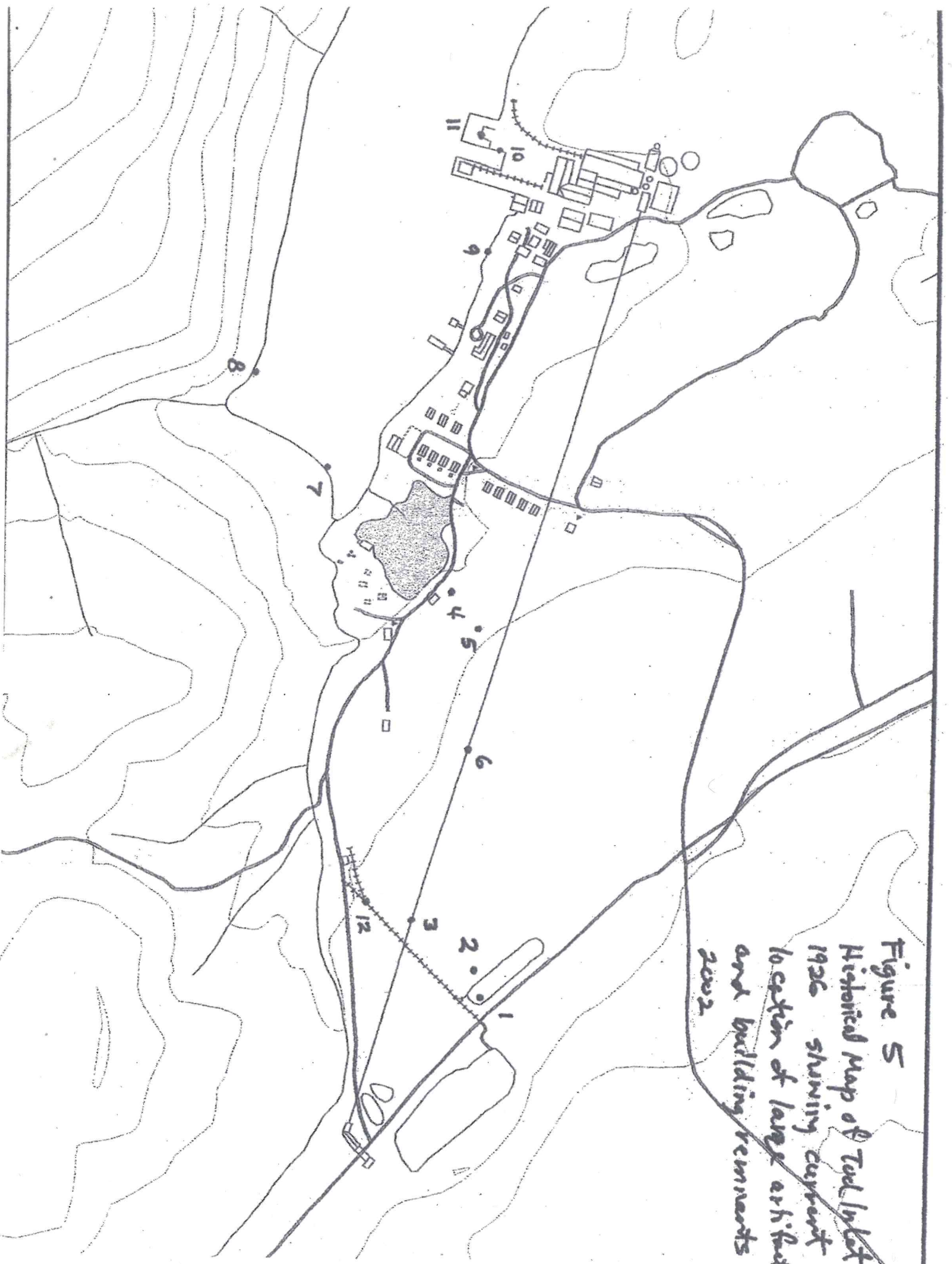

Figure 5
Historical Map of Tool Inlet
1926 showing current
location of large artificial
and building remnants
2002



OVERVIEW

NF = Nature Forest
 FH = Former house
 H = gate
 III = fencing

